

PROFESSIONAL STAGE & STUDIO EQUIPMENT



www.fortlamps.ru +7495 749 66 09 info@fortlamps.ru

KUPO[®]

PROFESSIONAL STAGE & STUDIO EQUIPMENT PROVIDER

WHO WE ARE

KUPO is one of the leading hardware solutions providers in the entertainment industry. We design, manufacture and distribute sophisticated products, including lighting and camera support, power connection, gear protection case, shopfitting display, lifting equipment and control systems.

For more than four decades, KUPO has established a well-recognized reputation for quality and innovation. Our customers are around the globe who work behind the scenes as the photographer, video and cine image-provider, theatre, concert hall, touring crews, and lighting designers. KUPO has forged its own path to the world by crafting innovative tools with unparalleled quality, sought after and shaped by industry professionals worldwide. To meet these professionals' needs, we offer numerous patent products including quick release and locking C-stand, multi direction easy storage Click Stand, auto self-locking Wind-up stand, lever lock and release device for Kupole, anti-slip rosettes friction disc of Max Arms, quick action Telescopic Hanger and the list goes on. All KUPO products have been painstakingly machined so you know you can count on their incredible strength and durability in harsh production environments. They are so durable, in fact, that they create a history of their own through their many years of service. Moreover its reliability is credited for certificates such as TUV-GS, CE, UL and CUL for several electrical products and the most popular Wind-up stand, Clamps, Couplers and Safety Wire.

OUR DRIVING FORCE

Our commitment to improvement is constant, we dedicate ourselves in creating Humanism, Quality, Invention and Safety to our people (both employee and customer), and our environment also to the booming content creation market. To those who work behind the scenes and stages, we consider you, the content creator, a partner, integral to our innovative process. We greatly value your experience and listen carefully to both your needs and desires, which inspires us to create better tools to empower your professionals to capture and share exceptional content. Enjoy your ride with us, when it comes to helping you achieve your vision dream with KUPO equipment,

**WE LIKE TO SAY AT KUPO:
*NEVER LET GO***



**YOUTUBE
KUPO FACTORY
INTRODUCTION VIDEO**

RIGGING SOLUTION INDEX

Chain Hoist	02 - 16
Flight Case	17
Chain Bag	18 - 19
Hoist Jacket	20
Hoist Controller	21 - 28
Mini Motor Pickle	29
Cable Sets	30
Beam Clamp	31
Shackle	32
Round Sling	33 - 35
Ratchet Strap	36
Braided Rope	37
Wire Winch	38

Content

At RIGPRO, we take pride in our ability to lift anything you rig! Our renowned RIGPRO chain hoist is designed and manufactured in Taiwan. With more than 40 years of experience, is celebrated for its exceptional mechanical design, sturdy die-cast structure, and meticulous craftsmanship. It stands tall as the epitome of excellence in its class.

But that's not all – we go beyond hoists. Our comprehensive range of rigging equipment caters to all your needs in entertainment rigging. From chain hoist controllers to chain bags, hoist jackets to beam clamps, shackles to cable sets, and braided ropes to webbing or steel round slings, we have it all. We are dedicated to providing tailored solutions that align with your specific demands.

Come and join us on www.stage.com.tw



YOUTUBE
RIGPRO CHAIN HOIST
MANUFACTURING
OVERVIEW



D8+
(IGVV SQP2)

D8+
(IGVV SQP2)

BGV D8
(IGVV SQP2)

RC-250P

RD-750P

RH-250

RC-250LV

RD-750LV





BGV D8
(IGVV SQP2)

BGV D8
(IGVV SQP2)

BGV D8
(IGVV SQP2)

RH-500

RH-1000PS8

RH-2000

RH-1000S8

RH-500P

RH-1000PS4

RH-1000S4

RH-500LV

RH-1000LV

RH-2000LV

RH-1000LVP



RC-250P & RC-250LV

Comply with D8+ (IGVW SQP2 2018)

Introducing the RC-250 series, a revolutionary addition to our RIGPRO portfolio. These cutting-edge rigging chain hoists are specifically designed to excel in lifting applications where headroom or clearance is limited. Ideal for theatres, exhibition halls, TV studios, hotels, shopping centers, schools, churches, arenas, sports centers, and event venues, the RC-250 series offers a compact and low-profile solution.

The RC-250 series is ingeniously crafted to meet the challenges of restricted spaces. Its innovative design allows for both lifting and climbing operations, making it an ideal choice for both mobile and installation rigging requirements. Say goodbye to the hassle and embrace pain-free rigging with the RC-250 series.



The size is exceptionally compact, allowing it to fit seamlessly within a 12" truss.

Compact, Lightweight, yet Robust

Simplified and streamline profile as 100x153x350mm, you can physically put this hoist into a 12" truss to save the head room, which is really helpful for the building with limited ceiling space for rigging. It is very lightweight, only 11.5kg deadweight, that requires minimal assistance for a qualified person to handle it. The housing is made of die-casting aluminum alloy, for the maximum strength in such small dimensions.

Higher Safety Gear

The hoist is equipped with two independent DC spring-loaded brakes as standard configuration when it is specified as D8, leveling up the operation safety. Additionally mechanical design is completely compliant with the tier of D8 plus. Slipping clutch, as overload protection, is situated outside the load path so as the brakes hold the load directly while disconnected with power. Adjusting the clutch torque is conveniently accessible through an Allen tool.

Reliable & Smooth Operation

The hoist is powered by a three-phase induction motor. With 2-step drive precisely-machined helical gears, the running noise stays as quiet as less than 65dB. Lifting speed is 4 meter per minute (50Hz) for steady operation



YOUTUBE
RIGPRO 250KG
CHAIN HOIST



Higher Safety Gear

Impressively lightweight, enabling a qualified person to handle it effortlessly without requiring additional assistance.

Only 11.5kg





5-pocket lift chain wheel for smooth and quiet lifting operation



Alloy steel helical gears used to cement 2-step drive system for quiet operation and long wear life



Friction clutch with lining is located outside the load patch so that the load is firmly held by brakes while hoist is disconnected from power



Double independently-acting spring-applied DC brakes allows for higher operation safety



Insulation class F motor (0.2Kw x 4P) for superior operation performance



Upper and lower hooks apply material SF45C to cast which allow swiveled 360 and are equipped with safety latch to enhance the loading safety



Die-casting aluminum housing for the greatest toughness and robustness, yet lightweight. Black epoxy powder finish for less visibility and corrosion resistance. Rated for IP65 with housing completely assembled and treatment.



Slide the positioning block along the chain to set up the hoist travel limit. Opening side cap to adjust is not required. Absolutely tool free.



Six colors available to fit the venue decoration or atmosphere (color reference: pink PANTONE 806C, yellow RAL 1028, red RAL 3020, blue PANTONE 2747C, white RAL7035 and black)



Fabricated from robust and sleek black POM material, the positioning block features a 5mm diameter perforated orifice, facilitating secure attachment to the chain with a cable tie to prevent slippage. Compact and convenient to hold and maneuver, it ensures chain link integrity without causing damage.



Chain guide and chain regulator is integrated in one piece for space saving and keeping the profile neat.



FEC Types DT, Grade 80, surface hardened for high strength, premium quality steel alloy chain

Technical Information

- Load Capacity: 250kg
- Type: RC-250P (direct control)
RC-250LV (24V low voltage control)
- Motor: 0.20KW x 4P
- Motor Isolation Class: F
- Operation Voltage: Three Phase AC 200V, 380V, 400V, 415V
- Lifting Speed: 4M/min (50Hz), 4.8M/min (60Hz)
- Load Wheel: 5-pocket
- Load Chain: Grade80, 4.0 x 12mm
- Duty Cycle: FEM 1Bm class, ED25% or 150 times on-to-off per hour
- Friction Clutch: Yes, located outside the load patch
- Chain Hoist Weight: 11.5kgs
- Chain Link Weight: 0.35kg per meter
- Incorporating a limit switch design in both DC/LVC version ensures the implementation of safety.

Capacity (kg)	Model	Speed(m/min) 50Hz/60Hz	Fall No.	Load Chain (Dia x Pitch) (mm)	Motor (kw x pole)	Weight of hoist (kg)
250 kg	RC-250P	4.0 / 4.8	1	Ø4.0 x 12.0	0.2 x 4P	11.5
250 kg	RC-250LV	4.0 / 4.8	1	Ø4.0 x 12.0	0.2 x 4P	11.5

Dimensions: (mm)

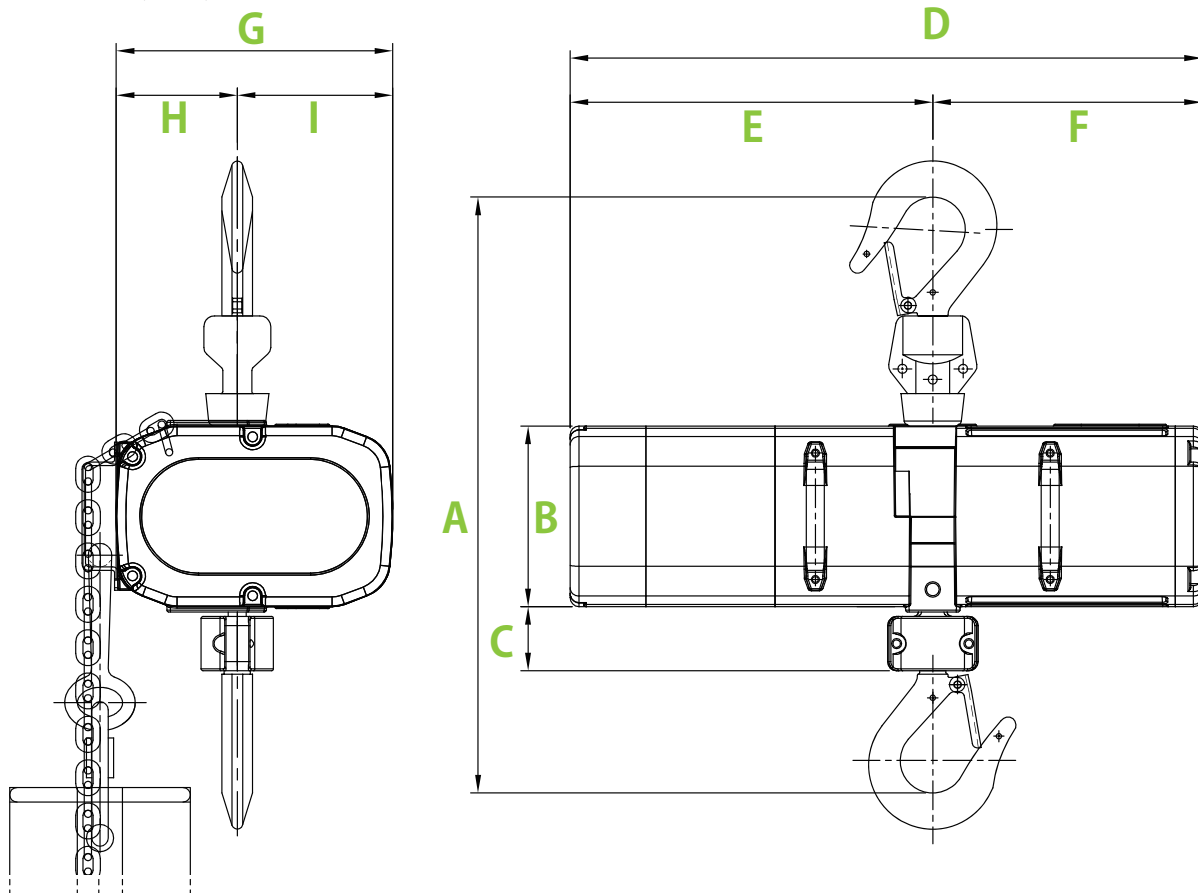

Model	A	B	C	D	E	F	G	H	I
RC-250P	350	100	35.5	350	200	150	153	67	86
RC-250LV	350	100	35.5	350	200	150	153	67	86

RD-750P & RD-750LV

Comply with BGV D8+ (IGVV SQP2 2018)

- Load capacity 750kgs (1 fall) with safety factor 8: 1
- Spring-applied double DC brake enhances the safety
- Overload friction clutch is located outside the load path

Those comply with specification of D8+, meeting IGVV SQP2 Code of Practice for entertainment rigging. It is designed for any climbing and upright applications.



YOUTUBE

RIGPRO BGV D8+ CHAIN HOIST



Outstanding Features

- 5-pocket liftwheel makes lifting smoother and less vibration
- Epoxy black powder coated for less visibility and corrosion resistance; with rubber gasket and mechanical design.
- Forward-curve enhanced Nylon chain guide is robust and keeps chains running smoothly in the central.
- Two foldable handles provide an easy manner for transportation of the hoist.
- Housing is fabricated of gravity die-cast aluminum; light weight yet robust and durable.
- Gears are made of alloy steel with heat treatment for steady operation and less wearing. Fine grounding on gears makes engagement precisely with less operation noise.
- Upper and lower hook are made of drop-forged high tensile carbon steel, allowing 360 degree freely swiveling.
- Over-Heat Protection: With built-in heat detector, when motor's inside working temperature reaches 140(±5) Celsius degree, the protection mechanism will trigger, and not allow lifting the load (DC version). Instead, it permits coming down to release the load (LVC version).
- Micro Switch Positioning (MSP) helps to set the up and down limit on travelling position without too much effort on direct control chain hoist (applied for both RD-750P & RD-750LV model).

Features



5-pocket lift chain wheel for smooth and quiet lifting operation.



Helical gears used to cement 3-step drive system for quiet operation and long wear life.



Friction clutch is located outside the load path and set at 125% load capacity while delivered.



Two independently-acting spring-applied DC brakes aim for higher safety standard.

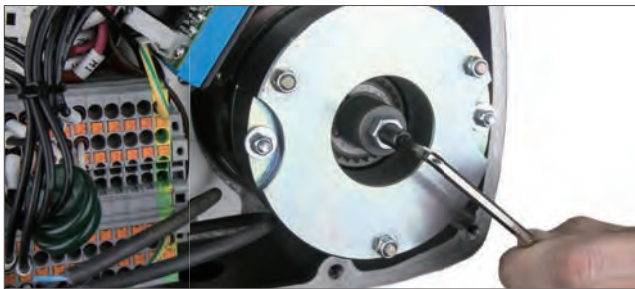

Adjusting clutch torque, if necessary, is convenient with an Allen key tool. Before adjusting, make sure to follow instruction in the user manual



Die-casting housing for the greatest toughness and robustness.



Insulator class F motor (0.75Kw x 4P) is well engaged inside the aluminum frame for excellent working thermal control.

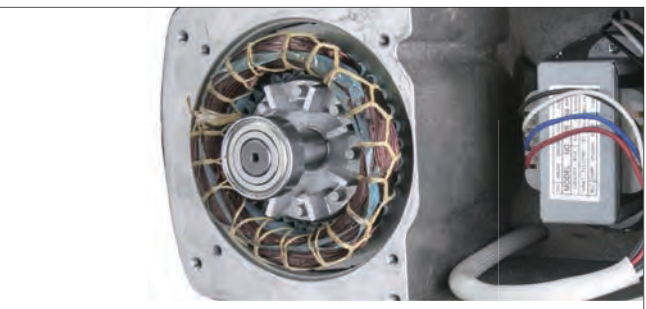

Foldable grips make transportation easy, and reduce the interference over the operation.



Micro Switch Positioning (MSP) provides an easy manner for DC hoist to set the up or down travelling position without too much effort. (Applied for both RD-750P & RD-750LV model).

Specification

- Load capacity: 750kgs
- Type: RD-750P (direct control)
RD-750LV (24V low voltage control)
- Motor: 0.75KW x 4P
- Motor isolation class: F
- Lifting speed: 4M/min (50Hz), 4.8M/min (60Hz)
- Load wheel: 5-pocket
- Load chain: Grade 80, 7.1 x 20.2mm
- Duty cycle: 2m FEM class, ED 40% or 240 times on / off per hour
- Operation voltage: AC 400V / 50Hz
- Friction clutch: outside the load path
- Chain hoist weight: 50kgs (without chain)
- Chain weight: 1.1kgs per meter
- With Micro Switch Positioning(MSP)

Capacity (kg)	Model	Speed(m/min) 50Hz/60Hz	Fall No.	Load Chain (Dia x pitch) (mm)	Motor (kw x pole)	Weight of hoist (kg)
750 kg	RD-750P	4.0 / 4.8	1	Ø7.1 x 20.2	0.75 x 4	50
750 kg	RD-750LV	4.0 / 4.8	1	Ø7.1 x 20.2	0.75 x 4	50

Dimensions: (mm)

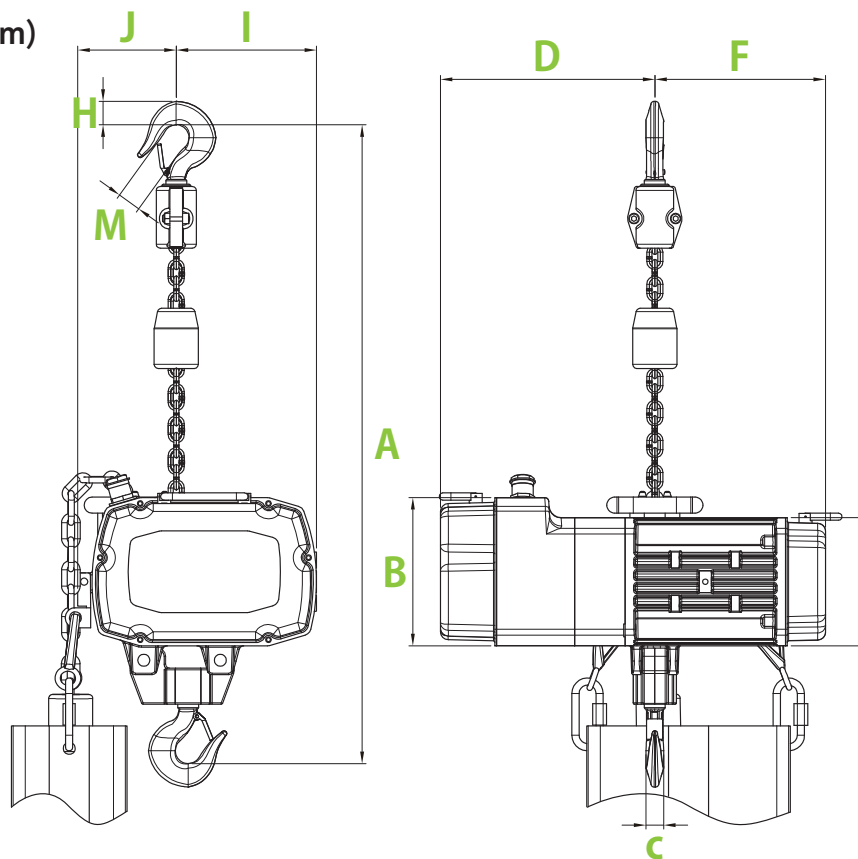

Model	A	B	C	D	F	H	I	J	M
RD-750P	650	185	23	267	213	33	175	123	30
RD-750LV	650	185	23	267	213	33	175	123	30

Codes of Practice for Event Technology

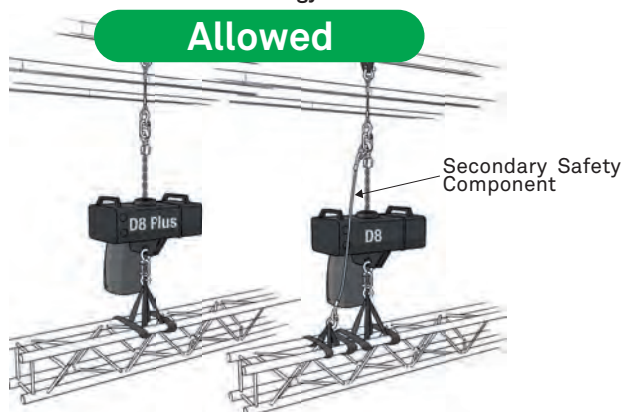

Safety Electrical Chain Hoist (D8 Plus and D8) 😊



Unsecured Electrical Chain Hoist (D8) 😞

RH-1000P Series

Comply with BGV D8 (IGVW SQP2 2018)

“Micro Switch Positioning” For Chain Hoist.
A better rigging choice you shouldn't miss out.

RH-1000P is designed for installation where chain lifting or hoist climbing to precise position is required. This new model offers the lifting operation an alternative manner in position control over simple and quick steps of maneuver.



YOUTUBE
RIGPRO ALL NEW
RH-1000P DC CHAIN HOIST



YOUTUBE
RIGPRO RH-1000P ELECTRIC
CHAIN HOIST (APPLICATION)



Convenient & Fast Setting

Each RH-1000P chain hoist comes with built-in micro switches and is equipped with up and down rubber blocks. Activate this system is just simple as 1-2-3: slide the rubber block to the desired position where you want to stop the moving, run the chain hoist with ordinary DC (direct control) controller, and then the lifting or climbing will stop while rubber block touches the micro switch on the nylon chain guide. No complicated setting; it's no brainer.

Precise & Safe

Whilst rubber block is fixed and running to touch the micro switch, the hoist will stop travelling immediately without delay, even the controller is set on working in this stage. In the case of multiple chain hoists in operation, as soon as the micro switch is triggered on each unit, hoist won't move an inch which ensures the fidelity to entire system's stability and safety.

Micro Switch Positioning (MSP) applicable to RH-500P RH-1000PS4 and RH-1000PS8



Rubber block has a dia. 5mm perforate hole, leaving a cable tie to anchor the rubber block on chain tightly from slipping. Palm-size rubber block is handy to grip and slide. Damage-free on chain link and durable for frequent use.



RH-1000 Series

Comply with BGV D8 (IGVV SQP2 2018)

RIGPRO RH-1000 is a three phase chain hoist, loading rated for 1000 kgs, and built for rigorous entertainment rigging environment. RH-1000 is available with DC (Direct Control) and LVC (Low Voltage Control) version, and operates in both upright and inverted positions.



YOUTUBE

OVERVIEW FOR RIGPRO ELECTRIC CHAIN HOIST

Outstanding Features

- Gravity die-casted aluminum, matt-black non reflective finish chassis for rigid, light-weighted, durable and low visibility.
- Epoxy black powder coated chassis is featuring corrosion-resistance, and with fine gasket and mechanical design, the complete unit turns to be IP54 rated.
- Enhanced Nylon chain leading plate ensures the chain links properly fit into the lift wheel, and eliminates the possibility of jamming, as well as protects the lift wheel from wet and dirt.
- Heavy-duty DC brake automatically gets engaged in the event of power failure, requiring very little maintenance and only minor periodic adjustments.
- Hook is made of drop-forged high tensile steel with heat treatment, allowing 360 degree swiveling, and equipped with safety latch to ensure proper rigging the load.
- Equipped with duty cycle ED 40% high efficiency, lightweight and robust motor, running the chain hoist quietly and steady.
- Operates on three phase voltage of 400V/50Hz, and LVC is 110V as standard. Other voltage for DC and LVC version is available upon request.
- Conforms to FEM 2m / ISO M5 classification, covering a wide range of applications.
- Average operational noise is within 75dB, quietly working and less noisy.

Safety Features

- DC Motor Brake: With two-side single disk brake, electro-magnetic brake actuates synchronously in the event of power failure to ensure the operation safety while loading.
- Overload Slipping Clutch: Protects the hoist from damage of overload, and ensures the life-span of chain hoist.
- Over-Heat Protection: With built-in heat detector, when motor's inside working temperature reaches 140(±5) Celsius degree, the protection mechanism will trigger, and not allow lifting the load (DC version). Instead, it permits coming down to release the load (LVC version).
- Gear Limit Switch (only applied for LVC version): Upper and lower limit switches are fitted to switch off the power simultaneously in the case of over lifting or lowering position.
- Phase Protection (only applied for LVC version): Built with phase error relay, in case of any phase missing or incorrect, the machine will not be in active, ensuring the safety and durability to all components.



Features



Made of enhanced Nylon and comply with housing design to facilitate the smooth operation of load chain. Forward-curve shape keeps chain running in the central position, away from getting stuck in the farther sides (except for RH-250 and RH-2000 as these two models are supplied with pulley type chain guide)

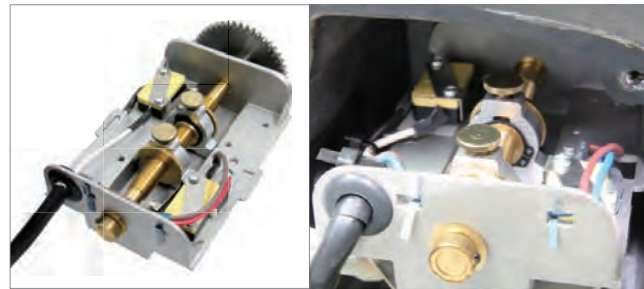

It can be handy adjusted to the required position, setting the chain travelling limits and offering the preventable method for hoist from over winding and damage.



Gear is made of alloy steel with heat treatment for steady operation and less wearing and tearing. Fine-ground gear makes engagement precisely with less operation noisy.



While generated torque is over the friction torque, the overload mechanism will trigger, in which motor keeps running but slipping clutch hold back the hoist from further lifting for the sake of safety.



Upper hooks apply material SF45C to cast which allow swiveled 360 and are equipped with safety latch to enhance the loading safety.

Lower hooks apply material SF45C to cast which allow swiveled 360 and are equipped with safety latch to enhance the loading safety. Connection plate is bend and formed by high strength steel for excellent safety.



Electromagnetic disk brake will brake synchronously while the power is off, ensuring the operation safety while loading.

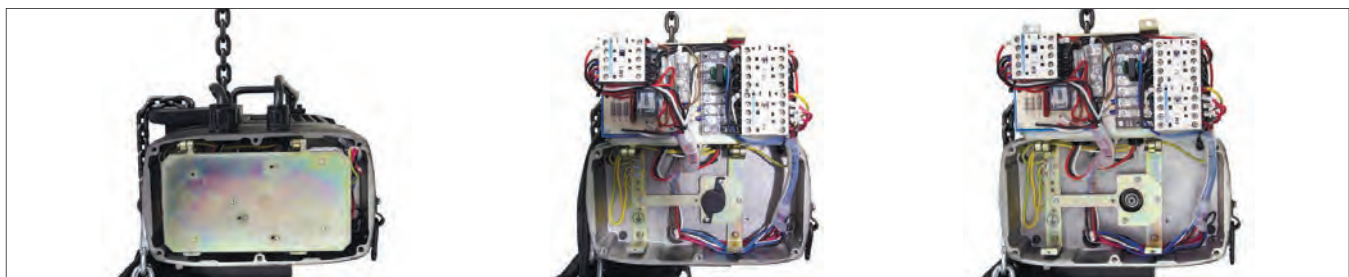

High performance fuse circuit breakers are fastened in a rotatable bracket for easy maintenance and inspection. The clutch torsion can be adjusted through a torque tool by a qualified technician. Easy to access and calibrate.

Capacity (kg)	Model	Speed (m/min) 50Hz/60Hz	Fall No.	Load Chain (Dia x pitch) (mm)	Motor (kw x pole)	Weight of hoist (kg)	Weight of alloy chain (kg / per meter)	Direct Voltage Control	Micro Switch Positioning	Low Voltage Control
2000	RH-2000	4.0 / 4.8	2	Ø 7.1 x 20.2	1.50 x 2	62	1.12	V		
	RH-2000LV	4.0 / 4.8	2	Ø 7.1 x 20.2	1.50 x 2	62	1.12			24V/110V
1000	RH-1000PS8	8.0 / 9.6	1	Ø 7.1 x 20.2	1.50 x 2	47	1.12	V	V	
	RH-1000S8	8.0 / 9.6	1	Ø 7.1 x 20.2	1.50 x 2	47	1.12	V		
	RH-1000PS4	4.0 / 4.8	1	Ø 7.1 x 20.2	0.75 x 4	47	1.12	V	V	
	RH-1000S4	4.0 / 4.8	1	Ø 7.1 x 20.2	0.75 x 4	47	1.12	V		
	RH-1000LV	3.3 / 4.0	1	Ø 7.1 x 20.2	0.75 x 4	47	1.12			24V/48V/110V
	RH-1000LVP	4.0 / 4.8	1	Ø 7.1 x 20.2	0.75 x 4	47	1.12		V	24V/48V/110V
	RH-500	4.0 / 4.8	1	Ø 6.3 x 19.1	0.40 x 4	42	0.89	V		
500	RH-500P	4.0 / 4.8	1	Ø 6.3 x 19.1	0.40 x 4	42	0.89	V	V	
	RH-500LV	4.0 / 4.8	1	Ø 6.3 x 19.1	0.40 x 4	42	0.89			24V/48V/110V
	RH-500LVP	4.0 / 4.8	1	Ø 6.3 x 19.1	0.40 x 4	42	0.89		V	24V/48V/110V
250	RH-250	4.0 / 4.8	1	Ø 4.0 x 12.0	0.25 x 4	30	0.35	V		

Dimensions: (mm)

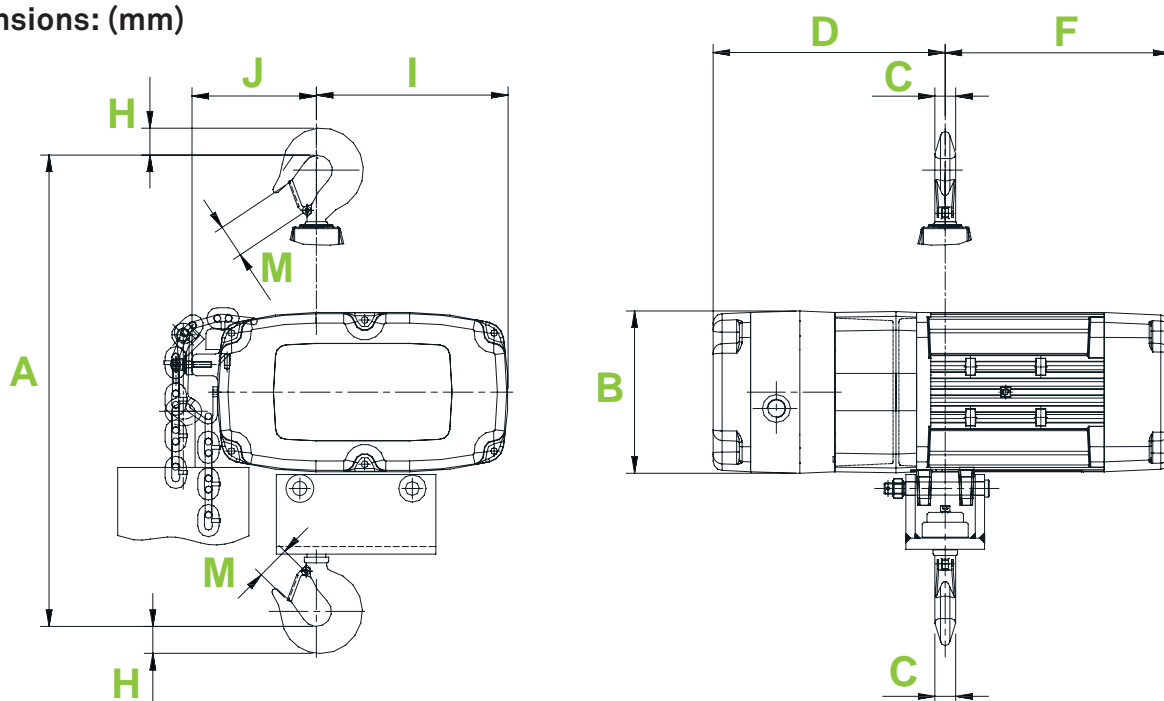

Model	A	B	C	D	F	H	I	J	M
RH-250	410	135	18	205	175	28	165	85	25
RH-500	600	156	23	247	221	33	185	105	30
RH-500P	600	156	23	247	221	33	185	105	30
RH-500LV	600	156	23	247	221	33	185	105	30
RH-500LVP	600	156	23	247	221	33	185	105	30
RH-1000LV	650	156	23	247	221	33	185	105	30
RH-1000LVP	650	156	23	247	221	33	185	105	30
RH-1000PS8	650	156	23	247	221	33	185	105	30
RH-1000S8	650	156	23	247	221	33	185	105	30
RH-1000PS4	650	156	23	247	221	33	185	105	30
RH-1000S4	650	156	23	247	221	33	185	105	30
RH-2000	860	170	27	275	240	39	170	170	30
RH-2000LV	860	170	27	275	240	39	170	170	30

Bringing together technology and convenience seamlessly, we proudly present the next generation of Permanent Magnet Brushless DC Electric Hoist. This hoist offers revolutionary energy-saving performance, superior durability, and versatile functionality, enhancing your workspace significantly. Whether in heavy or light sectors, this hoist ensures exceptional performance and reliability, ushering your work environment into the future with groundbreaking technology.

Plug-and-play single-phase connectivity

No need for complex installation procedures. This hoist can be directly connected to standard electrical outlets, providing immediate support for your operations and saving valuable time. Wide range voltage input of AC/90-270V (50/60Hz) for household electricity.

Permanent magnet brushless DC motor

With insulation class F, the hoist utilizes cutting-edge energy-saving technology not only reduces energy consumption but also lowers your operational costs, all while being environmentally conscious. Low starting current compared to ordinary motor, energy-efficient and eco-friendly. Longer lifespan to reduce maintenance cost. Duty cycle rated at 30% ED (FEM/1Am, ISO/M4) classification.

Rugged and durable, adaptability across work environments

Crafted from premium die-cast aluminum housing with IP 55 rated, this hoist is built to withstand extended periods of use, effortlessly handling challenges across factories, warehouses, and construction sites. Standard lift of 3 meters and custom lift is available up to 20 meters (pendant control version)

Variable speed functionality

Equipped with innovative VFD (variable-frequency drive) driver for intelligent dual speed and infinitely variable low motion control through adjustable pendant button, you have the freedom to adjust operational speed according to diverse job requirements, achieving heightened operational flexibility.



Sturdy, compact and lightweight. Chain container and control pendant is detachable from the hoist, making the whole set of the chain hoist convenient and great mobility for the storage with on-the-go plastic hard case.



Crafted for use in single-phase electricity environments, it is designed to provide the utmost accessibility and convenience for all your rigging needs.

Innovative VFD (variable-frequency drive) driver unit enables seamless dual-speed control for single-phase motors with unparalleled flexibility. Thermal Protection 85 (+/- 5) Celsius under VFD driver unit detection.

Control pendant with 3 meter cable offers Up/Down operation with variable speed control. By hard pressing the button, the hoist will run with full speed; by light pressing, the speed is controllable with adjusting the knob, longer length available upon request.



Wireless remote station (optional with specific model) provides up to 100 meter hassle-free operation. Press green button to retrieve the operation while E-stop has been activated earlier.

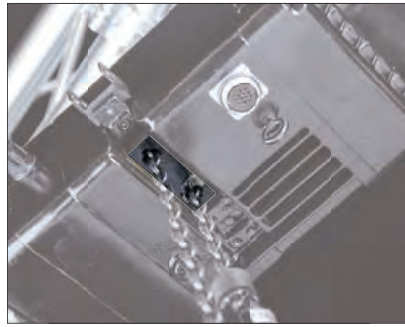

Up/Down limit switch enhance the operation safety by halting the operation while the switch is activated by the metal block at the far end of the chain

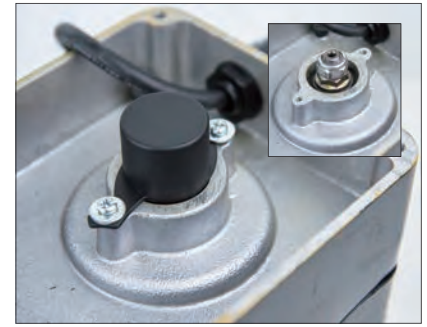

Clutch torque is set at 125% as standard. It is adjustable by turning the hex nut clockwise to increase, or counter-clockwise to decrease.

Model	RH-SP24	RH-SP24W	RH-SP48	RH-SP48W
Load Capacity (kg)	240		480	
Type	VFD (Variable Frequency Drive)			
Control	Pendant	Wireless Remote	Pendant	Wireless Remote
Motor (W)	600W x 8 P			
Rated Current (A)	10A (AC 110V), 5A(AC 220V)			
Motor Isolation Class	F			
Operation Voltage (AC)	Single Phase AC 90-270V (50/60Hz)			
Lifting Speed (M/min): slow / full	1.25~3.2 / 12.5		0.63~1.6 / 6.3	
Load Wheel	5-pocket			
FEM / ISO Classification	1Am / M4			
Duty Cycle	ED30%, or 180 times on-to-off per hour			
Brake	Mechanical Ratchet Load Brake			
Friction Clutch	Integrated with brake			
Load Chain	Grade 80, 4.0 x 12mm (according to EN 818-7)			
Standard Lift (M)	3 meters; longer lift available upon request			
Working Noise (dbA)	<75dB			
Chain Fall	1		2	
Chain Hoist Weight (w/o chain) (kg)	16		16.5	
Chain Link Weight (kg)	0.35			
Brief Case Dimension (cm)	50 x 21 x 39 (for standard lift 3M)			
Power Cable Length	3M			
Pendant Control Cable Length	According to lift request			

Dimensions: (mm)

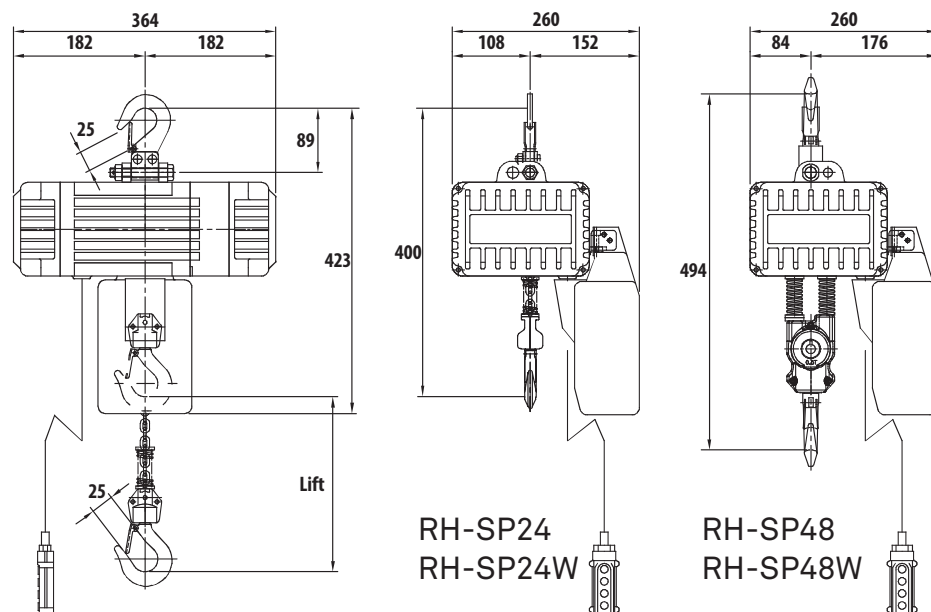

WE NEVER JOKE ABOUT THE ALLOY CHAIN. In overhead lifting applications, it is essential to use alloy chains of Grade 80 or higher. Additionally, for power-driven hoists, it is recommended to adhere to the EN818-7 standard guidelines, specifically Type DT and DAT.

Our hoists exclusively feature Japanese-made FEC chains that adhere strictly to the EN818-7 standard. These alloy chains not only meet the stringent compliance requirements but also harness the exceptional benefits of the original DT/DAT type. This results in premium performance characterized by optimal surface hardness and elongation properties.

Features

1. Made from chromium-molybdenum alloy, grade 80 chain load chain is precise calibrated and heat treated to optimal surface hardness and elongation properties to have longer chain life.
2. Black phosphate finish for corrosion resistance and low-key.
3. We exclusively utilize Japanese-made FEC chains in our hoists, with the option of RUD and pewag chains available upon request.



CHC-7.1 Type DT Grade 80 Alloy Chain

7.1 x 20.2 mm chain, Type DT (Grade 80), MBF: 63.0kN, Hardness: HV550min., Elongation: 12% min., per meter weights 1.12 kgs.

CHC-6.3/19.1 Type DT Grade 80 Alloy Chain

6.3 x 19.1 mm chain, Type DT (Grade 80), MBF: 50.0kN, Hardness: HV550min., Elongation: 12% min., per meter weights 0.89 kgs.

CHC-4.0 Type DT Grade 80 Alloy Chain

4.0 x 12.0 mm chain, Type DT (Grade 80), MBF: 20.0kN, Hardness: HV550min., Elongation: 12% min., per meter weights 0.35 kgs.

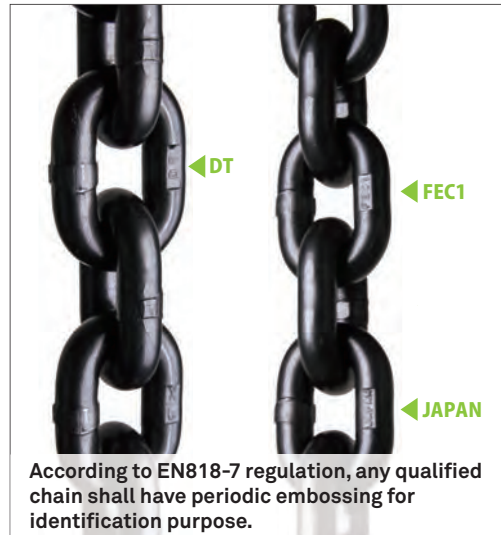

The chain slider is designed for cable management in entertainment rigging system. It is made in one piece with two fixing points for cable such as power, control, data or audio cables to get attached. Put several units on the chain in the electric chain hoist before applying the load, and while chain hoist is in operation the chain slider makes the cables neatly organized and well in position with up and down movement. No tool is required whilst putting chain slider in the chain. This chain slider cannot be attached or detached while the chain is under load.

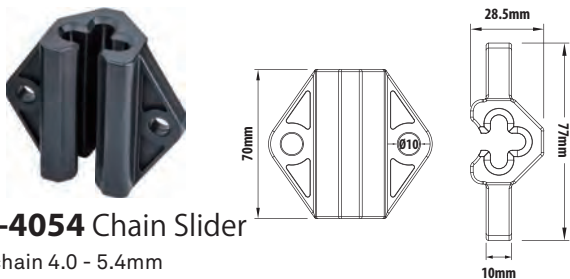

CS-4054 Chain Slider

for chain 4.0 - 5.4mm



CS-6371 Chain Slider

for chain 6.30 - 7.10mm

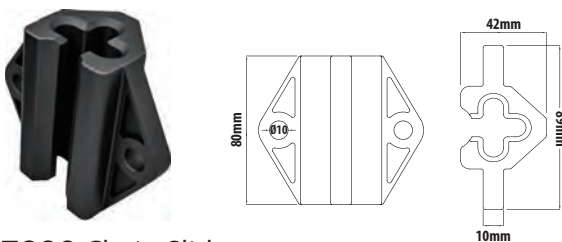

CS-7990 Chain Slider

for chain 7.90 - 9.00mm

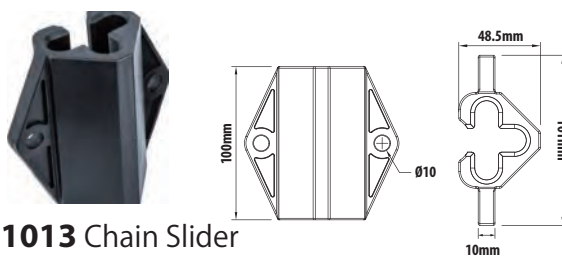

CS-1013 Chain Slider

for chain 10.0 - 13.0mm

Features

1. Made of sturdy and low friction black POM.
2. Quick and tool-free attachment with chain, without removing the hook.
3. Two fixing points (10mm hole) for shackle or cable tie to use.
4. Available in four sizes and suitable for wide range of entertainment rigging chain hoists.

Application



for Cable tie



for Shackle

RIGPRO chain hoist flight case is designed with several features for greater protection over transit. Made of 10mm thickness robust plywood with max durability. Stackable for less storage space. Internal layout is to set the chain hoist firmly and provide sufficient compartment for chain and power cable. Superior butterfly latches lock up lid and main frame tightly. Large spring-loaded handle for convenient grip and handling. Travel easily with four castor and two of them with brake. Robust and tough. It helps show tour to move in/out the chain hoist fast and extra secure to the equipment.



Lid is reinforced with hinged and two support lid stays.

RH-1000-1W Flight Case for RH-1000 & 500

Standard compartment for 20M chain, customized size for longer chain upon request.



Four dia. 10cm swivel castors for ease of transit; two of them with brake.



Recessed butterfly latches for secure lock.



Enhanced and rounded corner to brace and withstand unexpected collision.



Large spring-loaded handle for convenient grip and handling.

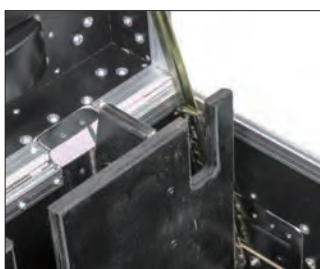

Hinged cover with multi-position lid stay.



Wood partition with black painting for extra strength and greatest support.

The RIGPRO chain bags are designed to assist with the containment of excess lifting chain, coming down from loads being hoisted, thus preventing common hazards associated with loss chains. The bag with the utmost consideration to safety, convenience and strength. This removable chain bag is made of high grade black fabric, 1000 deniers, and reinforced with 3.5cm wide rugged polyester strips.

Features

1. Three 3.5 cm straps crisscross the bottom to increase loading capacity.
2. 8 mm thickness acrylic plate on bottom distributes the chain weight evenly.
3. Upper metal frame keeps chain bag in rectangular shape.
4. 2 drainage holes on lower side to prevent accumulation of rainwater in case of outdoor use.
5. Made of high grade black 1000 deniers woven fabric.
6. Side strap with triple stitches.
7. Each chain bag comes with two eyehooks; quick link carabiners attached to the eye ring at two sides.

Note

1. The bags are sold individually including eyehooks and quick link carabiners for fixing them to the hoist.
2. Other size, styles and logo embossed are all available upon request.
3. The chain bag is compatible with all major brand chain hoist.
4. Max. recommended capacity for loading: 75% of bag space.
5. Under no condition should the hook block or load be permitted to come in contact with the chain bag. If contact is made, the function of the chain bag can be interfered and become imperiled.



CB-15 Chain Bag

Frame: 10 x 14.5cm / Height: 40cm (15")
 Max. Capacity: 75% of bag space, or 25 meters of 4.0 chain link.



YOUTUBE
KUPO CHAIN BAG



CB-12 Chain Bag

Frame: 12 x 25cm / Height: 30cm (12")
 Max. Capacity: 75% of bag space, or 15 meters of 7.1 chain link.



CB-18 Chain Bag

Frame: 14 x 25cm / Height: 45cm (18")
 Max. Capacity: 75% of bag space, or 25 meters of 7.1 chain link.



CB-22 Chain Bag

Frame: 14 x 25cm / Height: 56cm (22")
 Max. Capacity: 75% of bag space, or 40 meters of 7.1 chain link.



CB-36 Chain Bag

Frame: 14 x 25cm / Height: 90cm (36")
 Max. Capacity: 75% of bag space, or 60 meters of 7.1 chain link.



Each eyehook has WLL 750 lbs (340.19 kg) and dimension 7/16" embossed.



Each quick link carabiner has WLL 2200lbs (997.90kg) and Dia. 5mm imprinted.



The drainage hole on lower side to prevent accumulation of rainwater. 4 mm thickness acrylic plate to distributes the chain weight evenly.



Side eye ring for fasten a quick link carabiner and eyehook. This distributes the weight more evenly on opening frame. Three 3.5cm wide polyester straps to enhance loading capacity.

Fabricated of 1000 denier textile fabric with a heavy-duty hook, this round-shape chain bag can be attached to the chain block easily and provides a large compartment for accommodating chains. Supporting straps are stitched with the round frame directly so as to hold the weight firmly. Solid and flat bottom distributes the weight evenly, and three drain holes on the bottom keep the chain dry and rust-free.



Feasible for wide range of manual chain block.



Comes with carbon steel snap hook rated for WLL 750kgs.



strap and frame is secured with a leather cover to give the fabric greatest support.



three drain holes on bottom to evacuate the rainwater and keep the bag dry.

CB-C13 Chain Bag for Manual Chain Block

Dimensio: Dia. 25cm x 33cm (bag only)
 Length: 33cm / Load Capacity: 20 kgs

As its name, it is the jacket to fit over the hoist body (RIGPRO RH-1000 and all other major brand hoists) to help protect against rain ingress, dust, moisture, etc. It is made of 900 denier woven polyester and two coats of resin which proofs against the elements and provides long wearing. The standard color is black, CH-52B. Customized color and logo embossed upon request with minimum order quantity.

Why Need Hoist Jacket?

1. Complete protection: the design of rectangular cutout on the top and string in the bottom (to tighten the skirt) leaves the chain hoist from moisture and dust ingress.
2. Cosmetic & Valuable: hoist jacket gives chic appearance, keeps chain hoist low profile, and better than wrap hoist up with other materials.
3. Save time & Simple: only three steps like the followings and take really no time.



CH-52B Hoist Jacket

Description: Hoist Jacket for 1-ton chain hoist
Size: 530(L) x 330(W) x 280(H) mm

CH-52BP Hoist Jacket

Description: (Dustproof) Hoist Jacket for 1-ton MSP chain hoist
Size: 530(L) x 330(W) x 280(H) mm



Step 1: Put on



Step 2: adhere (via fastener)



Step 3: tighten up



CH-52B

RIGPRO offers a wide variety of controllers for professional entertainment rigging, including direct voltage control or low voltage control chain hoists. From single channel to 24 channels, hand-held to rack mount, all the controllers are built exclusively for the need in touring, event or production. Sophisticated and well-fabricated, RIGPRO's controllers bring and lift the operation experience to a further tier.



DC Chain Hoist Controller

RIGPRO 4, 8 and 12 channel direct hoist controllers are designed to withstand the rigorous touring environment, offering stand-alone or multiple-units control system for maximum flexibility. Tailor-made can be specified on request.

Features

1. Each brief case type of RIGPRO chain hoist controller is outfitted with CROXS water proof hard case.
2. The case features impact resistance, offering excellent protection to the components of controller over transit.
3. Lightweight and compact.
4. Occupy less space for ease of storage.



CHC-14-3P 4-CH Controller

Dimension: L 52 x W 42 x H 21 (cm)
Weight: 10.00 kgs (with water-proof case)



CHC-18-3P 8-CH Controller

Dimension: L 52 x W 42 x H 21 (cm)
Weight: 9.5 kgs (with water-proof case)



CHC-112-3P 12-CH Controller

Dimension: L 52 x W 42 x H 21 (cm)
Weight: 10.5 kg (with water-proof case)





Phase check for clear identification of respective incoming phases. Only when the phase sequence is correct does the equipment start to work. Phase missing displays on a red LED indicator and the equipment won't be functioning. Lockable E-Stop button and phase reverse switch as standard feature.

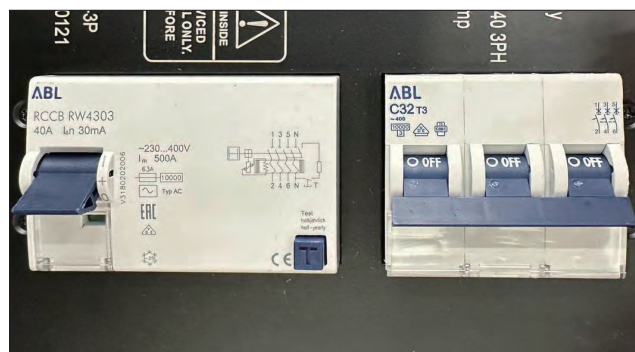

Overall MCBs (32A) & RCCB (30mA) ensure the working safety and stability.



Built up with 3-PIN XLR in/out connector as linkable ports for multiple system



Individual up/down rotary switch per motor for handy operation.

Hoist Power Connector			
Wire	L1	L2	L3
Motor_1	1	2	3
Motor_2	4	5	6
Motor_3	7	8	9
Motor_4	10	11	12
Earth	13-19		
Soca 19Pin	Pin Number		

Wiring information clearly disclosed on the front panel (for 8 and 12 channel controllers) in favor of the user making the corresponding cable assembly for chain hoist controlling system.



Phase reverse switch helps to convert the phase into correct sequence.



ONE CASE rock the whole world. Switching power supply for multiple input covering AC 220V, 380V, 400V and 440V for maximum flexibility.



Industry standard connectors: power input 32A 5P CEE receptacle; output 16A 4P CEE (4-CH), 19-PIN connectors (8, 12-CH). 4, 8 and 12 channel of direct control using reversing contactors built on the rear side of the panel.

This rack mount model is designed to accommodate for heavier rigging system. Its function is mostly the same as the briefcase type. The major difference is that rack mount type can be installed into standard 19" rack, like a portable dimmer rack system. It is available with 4-channel, 8-channel and the 12-channel. They are all linkable for larger scale of operation.

Features

1. Each controller is supplied with a 2M cable with 5pin CEE form 32A male connector.
2. Handle grips for easy & convenience installation.
3. Each unit comes with footpad for desktop operation.
4. Linkable with 3pin XLR for master/slave function.
5. Universal 3-phase power input – AC/220V, 380V, 400V and 440V for maximum flexibility.
6. Multiple LED indicators provides the clear information of the working status.
7. Overload and circuit leakage breaker (applied for 8CH and 12CH) keeps user away from working hazard.
8. Output for 4-channel is 4pin CEE form 16A female socket; 8-channel and 12-channel comes with Soca 19pin female socket.

YOUTUBE
RIGPRO CHAIN HOIST CONTROLLER
(DIRECT CONTROL)



CHC-14R-3P Rack Type Chain Hoist Controller (Direct Voltage Control)

Output: 4 x CEE 4-pin
Height: 3U



CHC-18R-3P Rack Type Chain Hoist Controller (Direct Voltage Control)

Output: 2 x Soca 19-pin
Height: 4U



CHC-112R-3P Rack Type Chain Hoist Controller (Direct Voltage Control)

Output: 3 x Soca 19-pin
Height: 6U

Assembled and integrated with robust flight case, these rack type chain hoist controllers are designed for controlling 12 or 24 units of DC (direct voltage) type chain hoists. Equipped with four noise-free swiveling castors (two of them with brakes) for the greatest mobility.



CHC-112RSX-3P

Integrated Rack Type Chain Hoist Controller (Direct Voltage Control)

12CH Integrated Rack Type Chain Hoist Controller
55cm (L) x 55cm (W) x 87cm (H) with castors

CHC-124RSX-3P

Integrated Rack Type Chain Hoist Controller (Direct Voltage Control)

24CH Integrated Rack Type Chain Hoist Controller
77cm (L) x 55cm (W) x 115cm (H) with castors



Three LED indicator (A, B, C) for clearly identification of incoming power phase status; 3-pin XLR input & output for synchronizing multiple units.

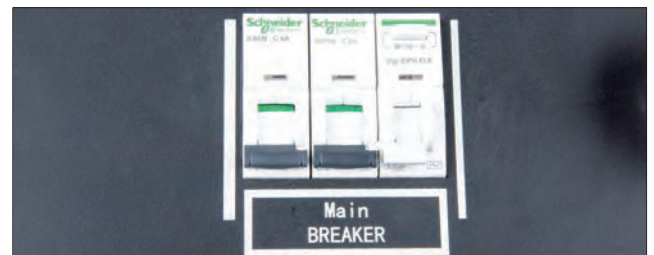

Main breaker for the control panel and the LED indicators is located at the top panel for turning on and off easily.



Rotary switch for setting each channel at up or down moving direction. LED will lift up showing the direction setting.



Pull down control stick to start "GO" function, and leaving the hand off to stop. Lockable E-stop to ensure the safety while there is emergency.

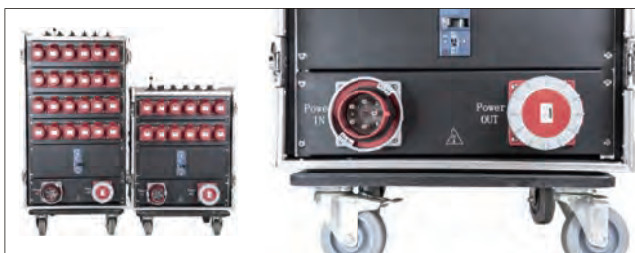

Connectors and breaker are entirely deployed at the same side; easy for checkup and operation.



Small compartment is convenient for the storage of cables and accessories, or personal belongings when in operation.



Main circuit breaker (MCB) at left side and earth circuit leakage breaker (ELCB) at right side for working safety. 100A over load protection for 24 channel and 63A for 12 channel. ELCB is suggested to set at 30mA(=0.03A) and 0.1s (=100ms).



Industry standard connectors: main power input & output is CEE form 63A 3P+N+E (IP67); for connecting chain hoist, the receptacle is CEE form 16A 3P+E (IP44).

Designed for accommodating 19" rack type chain hoist controller, this 16U flight case is fabricated of 9mm thickness plywood and coming with 4 casters for the need in frequent touring. Cage nuts are supplied for the user's convenience to fasten the controller on the square fixing positions. The add-on 3U drawer is key-secured which provides the user a handful storage compartment for their own utility.

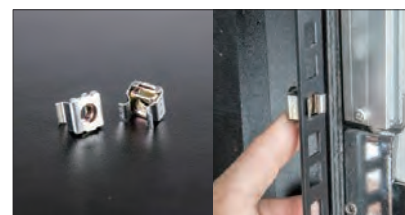

Cage nuts are supplied as standard accessory.

Flight case for Rack Type Controller

Fully closed for transportation: 530 (L) x 638 (W) x 754 (H) mm

Ready for rigging operation: 530(L) x 460(W) x 754(H) mm



CHC-11-3PL Direct Voltage Control Station

1 Channel Direct Controller for Tri-Phase Hoist.



CHC-12-3PL Direct Voltage Control Station

2 Channel Direct Controller for Tri-Phase Hoist.

Features

1. Housing is made of ABS for greatest impact-resistance and maximum durability.
2. For three-phase (AC 220/380/400/440V) chain hoist control directly; additional magnetic switch is no required.
3. Unique mechanical interlock design which helps to prevent short circuit.
4. Orange indicator will light up while it is connected with electricity.
5. With emergency stop mushroom button.
6. 3M long cable for both input and output for usage flexibility.
7. Connector: 32A CEE form 5pin (input) / 16A CEE form 4pin (output).



CHC-11LVC-3P Low Voltage Control Station

One Channel Low Voltage Controller for Tri-Phase Hoist.

Features

1. Housing is made of ABS for greatest impact-resistance and maximum durability.
2. For up and down operation for low voltage control chain hoist (24/48/110V).
3. With 3M long cable (4C x 2.0mmsq).
4. Connector: 16A CEE form 4pin male connector.

RIGPRO LVC controller is developed to operate low-voltage controlled chain hoists for entertainment rigging applications. It is made of sturdy metal housing with compact design, making it durable with tour life and staging operation. The “Go” button and channel selection toggles are built on remote handset which reduces the layout space of power station control panel and makes the profile slim and compact. Two M10 threaded holes on the back of chassis for easy attachment with clamps to rig on the truss.

Features

1. Four channels of 3-phase hoist power distro and low-voltage control.
2. Standard NEMA compliance power and control connectors.
3. Heavy-duty yet compact metal chassis for rigorous touring and staging.
4. Phase reverse switch helps to correct the phase sequence instantly and effortlessly.
5. Control and working status clearly indicated by bright LEDs on power console.
6. “Contactor Enable” for the convenient operation to run the hoist with pocket pickle.

Specification

1. Universal 3-phase power input (220 / 380 / 400 / 415V)
2. Aluminum alloy metal sheet chassis (T=2.5mm)
3. NEMA compliance turn-lock connector; Inlet: NEMA L16-30 (Mains), Outlet: NEMA L16-20 (Power), NEMA L14-20 (Control)
4. 30mA leakage circuit breaker & Max. 40A overload breaker.
5. 7pin XRL connector for connecting remote handset and power station.



YOUTUBE
KUPO RIGPRO LVC
CHAIN HOIST
CONTROLLER



CHC-14RLVC-US LVC Controller

Power Console
4CH controller for low-voltage controlled chain hoist
Dimensions: 582(L) x 177(W) x 100(H)mm

CHC-RC16A LVC Controller

Remote Handset
16CH remote handset controller
Dimensions: 195 (L) x 121(W) x 64(H)mm

Operation Features



E-stop circuit features automatic self-detecting function. In case of the conditions including phase missing, incorrect phase sequence, disconnection between power console and remote handset, or adding on connection between remote handset and new power console, the E-stop will be triggered and the operation will be suspended. To restore the full operation, press “reset” button on the remote handset.



Introduction



All components are deployed in one side on power console for clear view and operation.



Two M10 threaded holes for lighting clamps to attach for rigging on the truss.



16CH remote handset is connected with power console through 7-pin XLR; No additional power or battery is required for handset (7pin cable set is optional; please specify this in your request or order)

Handheld brackets protect the toggles from being damaged. While E-stop is pressed, the operation of any power console connected with this device will stop. To resume the function, release E-stop and press "reset" button.

Drawing

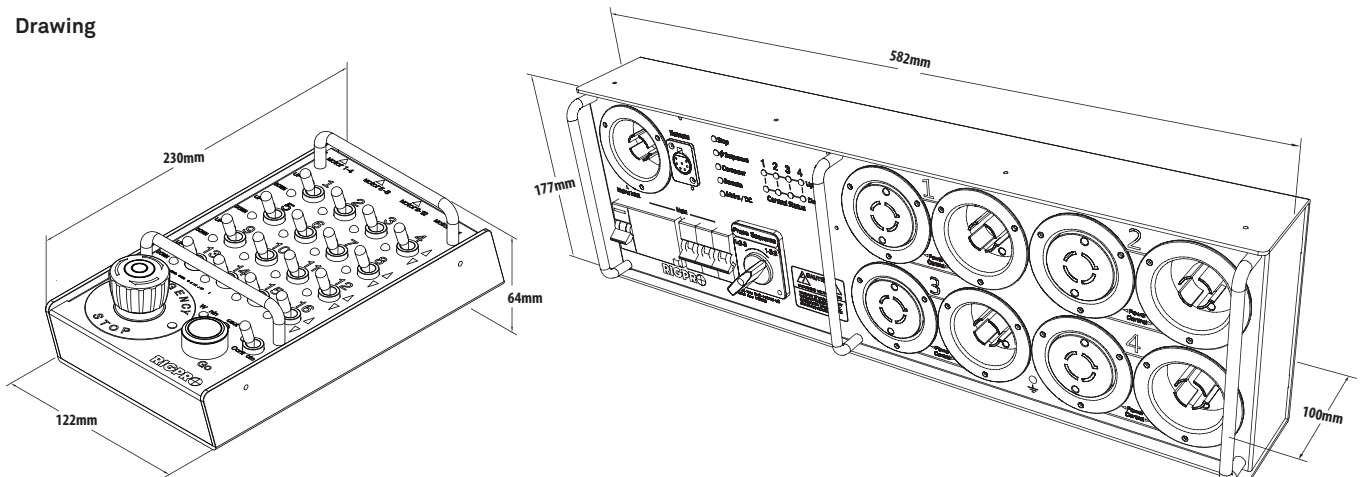

Mini Motor Pickle is designed for LVC(Low Voltage Control) type chain motor. It is must-have gadget to rigger's belt. Three LEDs in the rear chassis help rigger to identify the condition of the hoist on the go. Red LED shows the power is well connected; Yellow and green indicates respectively UP or DOWN direction while running the chain. It is built up rocker switch which will immediately and automatically stop the movement while your finger or thumb leaves the switch. Carabiner is attached for rigger's most mobility. CEE 16A/4P and Turn-lock 20A/4P are available. Mini Motor Pickle is ready for professional rigger to guide your chain in & out between your finger tip.

Features

1. Lightweight & portable.
2. Up and Down control from a rocker switch.
3. Power LED indicates once chain motor power is connected.
4. Different color of LED indicates Up & Down direction.
5. Belt clip is included.



YOUTUBE
MINI MOTOR PICKLE AKA POCKET PICKLE
FOR CHAIN HOIST

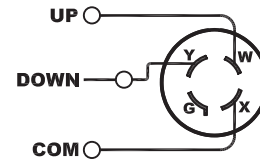

CHP-1 Mini Motor Pickle (Turn-lock 20A / 4 pin)
 CHP-1 Mini Motor Pickle w / NEMA L14-20 4 pin 20 amp plug.

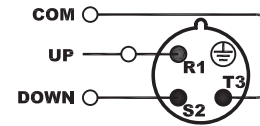

CHP-2 Mini Motor Pickle (CEE 16A / 4 pin)
 CHP-2 Mini Motor Pickle w / CEE 16-4h 3P+E 16 amp yellow plug.

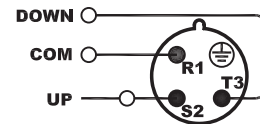

CHP-2E Mini Motor Pickle (CEE 16A / 4 pin)
 CHP-2E Mini Motor Pickle w / CEE 16-4h 3P+E 16 amp yellow plug.

How Does It Work?



Step 1

Once chain hoist power is connected the power LED indicator will on. Let you know the motor is ready to go.



Step 2

Up direction with Green LED indicator to tell correct operation way even in dark.



Step 3









Down direction with Yellow LED indicator to tell correct operation way even in dark.



Application

Lightweight & portable. Up and Down control from a rocker switch.

We provide various cable sets for direct control and low voltage control hoist.

Hoist Control Cable Sets	Cat. No.	Input	Output	Cable Length
	MCA-0404P-100	CEE Plug (3P+E)	CEE Connector (3P+E)	10M
	MCA-0404P-200			20M
	MCA-1919P-100	PLS 19-Pin Male	PLS 19-Pin Female	10M
	MCA-1919P-200			20M
	MCA-1616P-100	Harting 16-Pin Plug	Harting 16-Pin Socket	10M
	MCA-1616P-200			20M
	MCA-0404C-100	CEE Plug (3P+E), Yellow	CEE Connector (3P+E), Yellow	10M
	MCA-0404C-200			20M
	MCA-1604P-5	Harting 16-Pin Plug	CEE Connector (3P+E) x 4pcs	0.5M
	MCA-1904P-5	PLS 19-Pin Male	CEE Connector (3P+E) x 4pcs	0.5M
	MCA-0416P-5	Harting 16-Pin Socket	CEE Plug (3P+E)	0.5M
	MCA-0419P-5	PLS 19-Pin Female	CEE Plug (3P+E)	0.5M

Motor Power Connector Red 415V 16A 4 Pin CEE

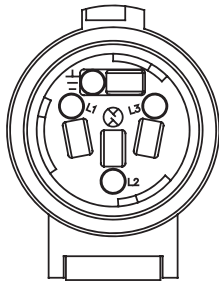

Soca 19 Pin

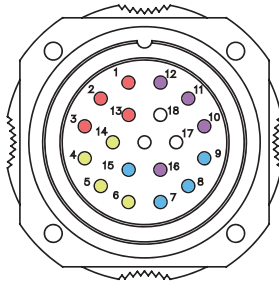

Multi 16 Pin

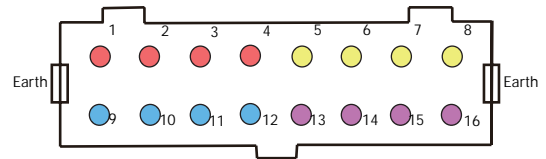

	Wire	Color	CEE Pin	Soca 19 Pin	Multi 16Pin
Motor 1	L1	Red	1	1	1
	L2	White	2	2	2
	L3	Black	3	3	3
	GND	Yellow/Green	PE	13	4
Motor 2	L1	Red	1	4	5
	L2	White	2	5	6
	L3	Black	3	6	7
	GND	Yellow/Green	PE	14	8
Motor 3	L1	Red	1	7	9
	L2	White	2	8	10
	L3	Black	3	9	11
	GND	Yellow/Green	PE	15	12
Motor 4	L1	Red	1	10	13
	L2	White	2	11	14
	L3	Black	3	12	15
	GND	Yellow/Green	PE	16	16
				17	
				18	
				19	

RIGPRO adjustable beam clamps provide a temporary or permanent mount to a wide range of beams, pipes and bars, where round, square rectangular in section. These units are designed to provide quick and versatile rigging point for hoisting equipment, pulley blocks or loads. Quick and simple installation is achieved easily by hand without tools. Units accommodate hook-mounted hoist or load blocks just with minimal loss of headroom. The clamp jaws are made to diminish beam stress by applying the load inside of the flange edge.

Features

1. Capacity: Rated loads from 1-3 ton in safety factor 4:1 for vertical lifting.
2. Built-in suspension bar offers low headroom.
3. Easy installed and adjusted by hand, no tools required.
4. Tested at 150% of rated load prior to shipment.
5. Black finish for blending into stage surrounding.
6. Heavy duty construction allows safer and secure grip in the beam.
7. Each unit is serialized, supplied with a test certificate and manual.
8. Adjustable threaded mechanism fits securely on a wide range of flange widths and beam sizes.



RBC-1BK Beam Clamp

WLL Capacity: 1,000 kgs
Adjustable Width: 75 - 220 mm

RBC-2BK Beam Clamp

WLL Capacity: 2,000 kgs
Adjustable Width: 75 - 220 mm

RBC-3BK Beam Clamp

WLL Capacity: 3,000 kgs
Adjustable Width: 80 - 320 mm



Special clamp design distributes weight away from flange edges.



Built suspension bar offers low headroom.



Adjustable threaded mechanism fits a wide range of beam size.

Shackles play a crucial role in lifting, securing, and rigging heavy loads, serving as the ultimate link in chain or sling configurations. Our shackle series distinguishes itself through outstanding strength and durability, making it the preferred option for demanding lifting and rigging tasks. Meticulously engineered and constructed from top-grade materials, our shackles offer unwavering performance in challenging conditions, ensuring the safety and trustworthiness professionals rely on.

Forged Anchor Shackle, Carbon Steel or Alloy Steel

1. Shackles are Type Approved by DNV & ABS.
2. Shackles are forged carbon steel or alloy steel with alloy pin, Dacormet Finish.
3. Size and Working Load Limit permanently shown on each shackle.
4. All shackles with Batch Code which links to Test Certificate and quality traceability.
5. 100% magnaflux crack detection during manufacturing.
6. 20,000 cycle fatigue rated to 1.5 times Working Load Limit.
7. Meet the performance requirements of Federal Specification RR-C-271D, Type 4A, Grade A or Grade B, Class 2/Class 3.
8. Minimum Ultimate Load is 6 or 5 times the Working Load Limit.

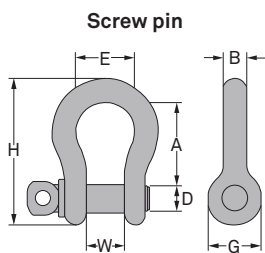
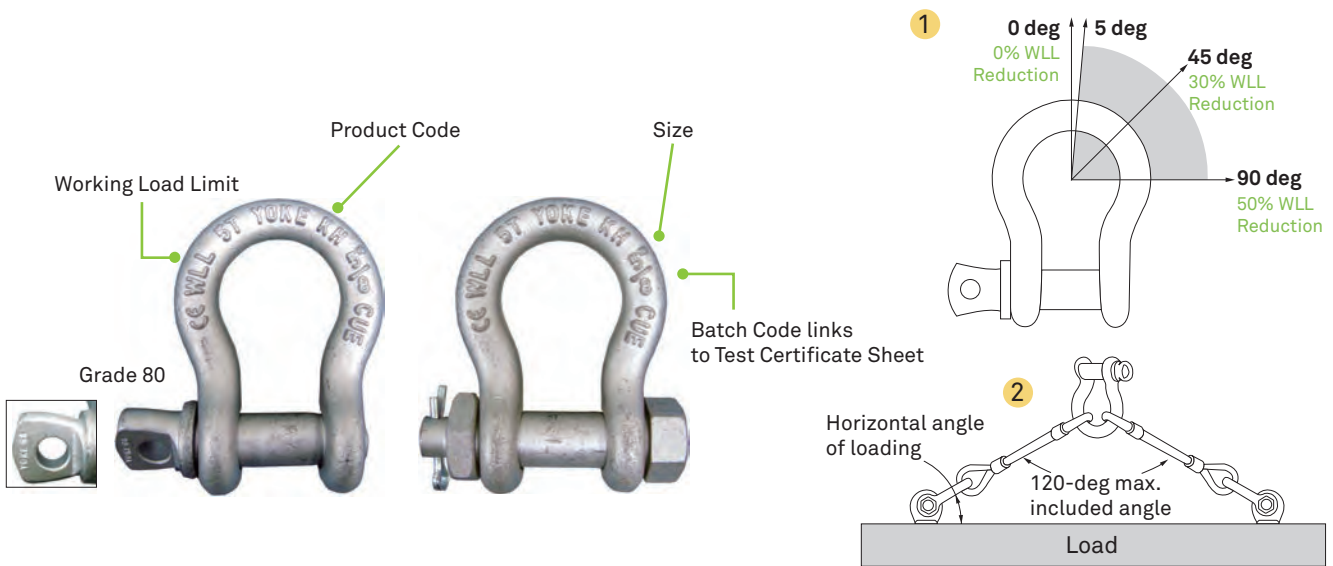

Item No.	Nominal Size (inch)	Material (Minimum Ultimate Load of WLL)	Working Load Limit (tons)	Dimensions (inch)							N.W. (lbs)
				A	B	D	E	G	H	W	
SS-S3250	5/8	Forged Carbon Steel (6 times)	3.25	2.40	0.63	0.75	1.70	1.50	4.17	1.06	1.3
SS-S4750	3/4	Forged Carbon Steel (6 times)	4.75	2.83	0.75	0.87	1.96	1.81	5.04	1.30	2.2
SS-S5000	5/8	Forged Alloy Steel (5 times)	5	2.40	0.63	0.75	1.77	1.53	4.21	1.06	1.3
SS-S6500	7/8	Forged Carbon Steel (6 times)	6.5	3.39	0.87	1.02	2.28	2.08	5.91	1.50	3.3
SS-S8500	1	Forged Carbon Steel (6 times)	8.5	3.78	1.02	1.1	2.68	2.67	6.57	1.73	5.1
SS-S12500	1	Forged Alloy Steel (5 times)	12.5	3.78	1.02	1.1	2.68	2.36	6.53	1.73	5.1

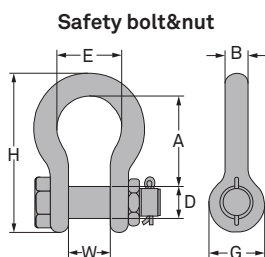

Item No.	Nominal Size (inch)	Material (Minimum Ultimate Load of WLL)	Working Load Limit (tons)	Dimensions (inch)							N.W. (lbs)
				A	B	D	E	G	H	W	
SS-N3250	5/8	Forged Carbon Steel (6 times)	3.25	2.40	0.63	0.75	1.70	1.50	4.17	1.06	1.5
SS-N4750	3/4	Forged Carbon Steel (6 times)	4.75	2.83	0.75	0.87	1.97	1.81	5.04	1.30	2.2
SS-N5000	5/8	Forged Alloy Steel (5 times)	5	2.40	0.63	0.75	1.77	1.53	4.21	1.06	1.3
SS-N6500	7/8	Forged Carbon Steel (6 times)	6.5	3.39	0.87	1.02	2.28	2.09	5.91	1.50	3.7
SS-N8500	1	Forged Carbon Steel (6 times)	8.5	3.78	1.02	1.1	2.68	2.40	6.57	1.73	5.3
SS-N12500	1	Forged Alloy Steel (5 times)	12.5	3.78	1.02	1.1	2.68	2.36	6.57	1.73	5.3

Warning

- 1 Don't exceed the shackle capacity. Shackle capacity decrease subject to the angle of loading.
- 2 When two slings are used on a shackle, the load rating is based on the load regardless of the inclined angle as long as it is less than 120 degree.

Polyester round sling but steel wire rope inside. This sling is composed of dia. 1.5mm steel wire in 34 loops, making it most flexible with superior strength. Inspection window covered by lid provides convenient access to check the wire rope. Identification labels are included under this lid. Heat resistance up to 150°C. Load capacity 2,000kgs with safety factor 5, whereas it turns to be load capacity 1,000kgs according to BGV-C1 with safety factor 10. Minimum bending radius R=6mm.



**YOUTUBE
KUPO SOFT
STEEL ROUND SLING**



RS-S102 Steel Round Sling

Length: 1M
Load Capacity: 2,000 kg

RS-S202 Steel Round Sling

Length: 2M
Load Capacity: 2,000 kg

RS-S302 Steel Round Sling

Length: 3M
Load Capacity: 2,000 kg



RS-S402 Steel Round Sling

Length: 4M
Load Capacity: 2,000 kg



RS-S502 Steel Round Sling

Length: 5M
Load Capacity: 2,000 kg



Inspection window for checking the steel wire easily.



Identification labels clearly reveal the specification of this sling.

Working Length Required

As defined by arrows meaning circumference of complete sling when laid flat, so called "pull to pull" length.

Sling Angle

When slings are used in a basket hitch and suspended from one hook, sling angles will directly affect the rated capacity of any sling. Sling capacity decreases as the angle from horizontal decreases.

Working Load Required

Subject to heaviest loads, lifting conditions, and angles.

How to measure length



one sling					
Capacity 2000kg	Vertical M : 1.0 2000kg	Choke M : 0.8 1600kg	Basket M : 2.0 4000kg	Basket M : 1.4 2800kg	Basket M : 1.0 2000kg

Sling Angle in Degrees	Factor
15	0.259
20	0.342
25	0.423
30	0.500
35	0.574
40	0.643
45	0.707
50	0.766
55	0.819
60	0.866
65	0.906
70	0.940
75	0.966
80	0.985
85	0.996
90	1.000

two slings

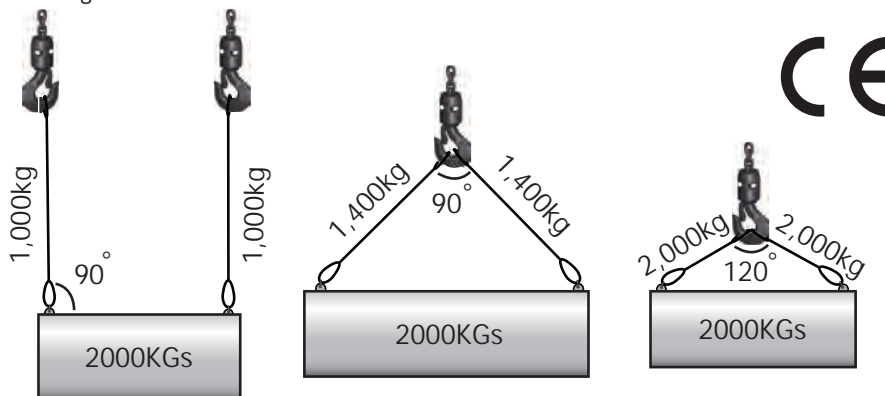

Warning

Never exceed working load limit of the sling. Sling capacity decrease as the angle from horizontal decreases. Sling should not be used at angle of less than 30.

RIGPRO polyester black stage sling is made according to ISO4878 DIN EN 1492-2, meets CE & GS safety regulation. It is an endless synthetic sling made from a skein of polyester core yarn covered by an independent, woven polyester tubular jacket. These lightweight round slings are ideal for easy and inconspicuous suspension of stage sound and lighting equipment. Black sleeve material helps sling blend into its surroundings.

Features

1. Lightweight reduces fatigue and strain on riggers.
2. Capacity stripes; each stripe is equal to 1 ton capacity.
3. Synthetic materials leaves hands free from cut injury.
4. Consistent matched lengths for better multiples sling load control.
5. No loss of strength from abrasion to cover.
6. Conforms to shape of load to grip securely.
7. Soft cover keeps load surface from scratch.
8. Low stretch (about 3% at rated capacity).
9. Conforms to shape of load for less load damage.
10. Lightweight and pliable for easy rigging and storage.
11. Independent core yarns choke tightly, but release easily after use.
12. Sling lifespan can be extended by rotating bearing points.
13. Each stage sling comes with an identification tag and serial number for traceability.
14. Easy to carry and transportation.
15. Working temperature: -40 °C to +100 °C.
16. Each stage sling is packed in plastic bag with CE declaration of conformity or test certificate.
17. Safety factor: 7 : 1



Polyester cover with Nylon fiber core



RS-005 Polyester Black Stage Sling

5 chained round sling 0.5M length
Load Capacity: 2,000 kg

RS-052 Polyester Black Stage Sling

Black stage sling 0.5M length
Load Capacity: 2,000 kg

RS-102 Polyester Black Stage Sling

Black stage sling 1M length
Load Capacity: 2,000 kg

RS-202 Polyester Black Stage Sling

Black stage sling 2M length
Load Capacity: 2,000 kg

RS-302 Polyester Black Stage Sling

Black stage sling 3M length
Load Capacity: 2,000 kg

RS-402 Polyester Black Stage Sling

Black stage sling 4M length
Load Capacity: 2,000 kg

RS-502 Polyester Black Stage Sling

Black stage sling 5M length
Load Capacity: 2,000 kg



Visible two black lines stands for load capacity of 2,000kg.



Identification label clearly reveals the specification of this sling.

This range of steel wire rope sling is manufactured according to EN 13414, the directive for steel wire rope slings in Europe. The single-leg steel wire rope sling is made of galvanized wire rope grade 1960 (rope class 6 x 19) to meet the permissible secondary safety component for entertainment rigging. Thimble at each end and ferrule-secured eye terminated. The inspection hole on ferrule guarantees the control of correct inserted length of wire rope before and after swaging, and comply with EN 13411 conical type C ferrule-secured termination.

Features

1. Comply with EN 13414-1, EN 12385-4, and EN 13411-1/-3.
2. Galvanized wire rope resists corrosion.
3. Ferrule inspection hole for convenient visual inspection.
4. Low dead weight but high working load capacity.

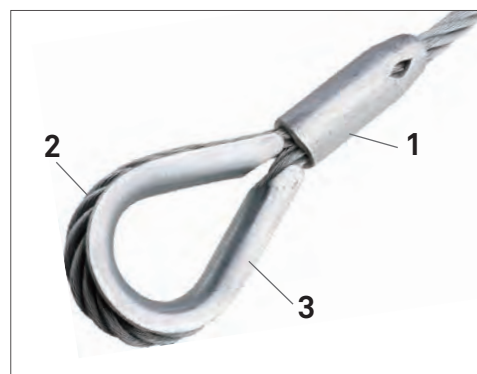

1. EN 13411-3 Type C cylindrical conical ferrule.
 2. EN 12385-4 Galvanized steel rope grade 1960.
 3. EN 13411-1 Thimble.

RSR-71901 Steel Wire Rope Sling

Dia. 10mm steel wire rope sling, Length 1M
 Load Capacity: 1000kgs

RSR-71902 Steel Wire Rope Sling

Dia. 10mm steel wire rope sling, Length 2M
 Load Capacity: 1000kgs

RSR-71903 Steel Wire Rope Sling

Dia. 10mm steel wire rope sling, Length 3M
 Load Capacity: 1000kgs

RSR-71910 Steel Wire Rope Sling

Dia. 10mm steel wire rope sling, Length 10M
 Load Capacity: 1000kgs

RSR-72001 Steel Wire Rope Sling

Dia. 14mm steel wire rope sling, Length 1M
 Load Capacity: 2000kgs

RSR-72002 Steel Wire Rope Sling

Dia. 14mm steel wire rope sling, Length 2M
 Load Capacity: 2000kgs

RSR-72003 Steel Wire Rope Sling

Dia. 14mm steel wire rope sling, Length 3M
 Load Capacity: 2000kgs

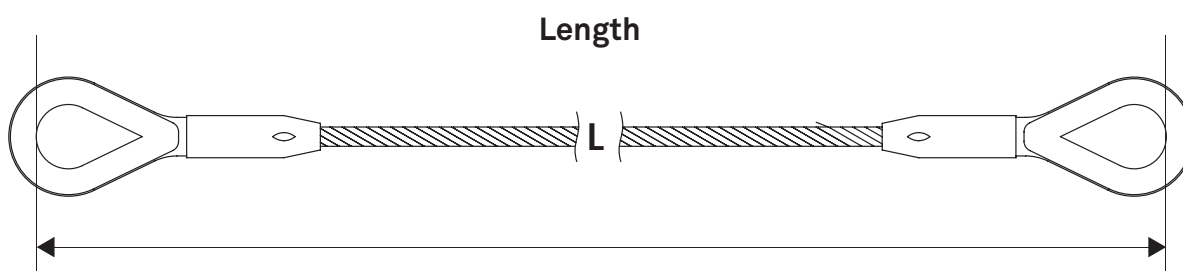

Ratchet Strap, also known as tie-down strap or ratchet lashing, is used to fasten equipment or cargo during transporting. Ratchet strap webbing is outfitted with tie-down hardware allowing strap to loop over the protected equipment or cargo and tighten up.

Specification

1. Webbing Material: Abrasion Resistant Polyester
2. Ratchet Material: Metal
3. Strap size: 25mm x 2.5M
4. Strap color: black
5. Load capacity: 1000kgs (not for lifting)
6. Safety factor 2:1
7. Compliance: BS EN 12195-2

Features & Advantage

1. Gradual release ratchet gives a quick tension of strap.
2. Positive locking latch for secure the tension.
3. Spring-loaded quick release function for easy strap removal.
4. Black webbing color for entertainment standard.



To Tie-Down

- Step-1: Pull latch toward handle to disengage the lock; insert slack webbing through buckle.
 Step-2: Pull latch to engage the tensioning area; release latch and rotate handle back and forth till strap is as tight as necessary.
 Step-3: Pull latch and close handle to fully engage lock.
 Caution: Do Not Over Tighten.

To Release

- Step-1: Pull latch to release the lock; move handle back and forth one notch at a time to release tension gradually.
 Step-2: When tension is released, pull latch and fully open buckle to allow webbing to unroll freely.

RS-RS2525 Ratchet Strap

Ratchet strap 25mm x 2.5M, black

A breakthrough for making use of ratchet strap easier! This tie-down strap is equipped with patent buckle which offers the greatest way to retract the loose strap quickly after releasing the tension. The spring-loaded reel, functioning like tap measure, provide the effortless operation. Simply pull off the webbing strap you need, attach the hook, and ratchet the strap tight. Release at 180 degree open position. To recoil webbing back to the reel, simply pull back the rewind pin and it will automatically retract the webbing. Easy and handy.

Features & Advantage

1. Ergonomic Vinyl-coated handle for easy grip.
2. With heat treated Vinyl Coated "S" hook.
3. Patented buckle with rewind pin for quick retract and recoil webbing.
4. Gradual release ratchet gives a quick tension of strap.
5. Positive locking latch for secure the tension.
6. Black webbing color for entertainment standard.

Specification

1. Webbing Material: Abrasion Resistant Polyester
2. Patent Ratchet Material: Metal
3. Strap size: 25mm x 4.5M
4. Strap color: black
5. Load capacity: 680kgs (not for lifting)
6. Compliance: BS EN 12195-2



RS-RRS2545 Retractable Ratchet Strap

Retractable Ratchet strap 25mm x 4.5M, black



RIGPRO rigging rope is constructed with a braided nylon core and polyester cover. The combination of the 2 materials in a rope has better performance on strength, controlled stretch and abrasion resistant. The inner rope and outer rope are generally designed to share the load fairly evenly. The inner rope is a braided core of energy absorbing nylon. The core is fully heat treated to enhance the rope's flexibility and prevent hardening in service. The 32 plait cover is soft yet durable and with the appearance of cotton but will not rot or degrade. Black cover is added prior to yarn production which makes color lasting longer and enhanced wear resistance.

Features and Benefits

1. Polyester / Nylon construction- (Polyester cover/ Nylon core) provide a greater range of chemical resistance. than the traditional Nylon / Nylon construction.
2. Strength- Exceptional tensile strength. For 7/16" (11mm) minimum breaking strength 3,000 kgs.
3. Braided Core- The core bends more easily with less fatiguing. This makes for better knot ability, better control through mechanical ascent/descent devices. Also, in the event of a cover failure, the rope core will remain intact, allowing the user to ascend/ descend over the core to get back to a stable portion of the rope.
4. Water Resistant- Having a polyester cover sheds water far more readily than a traditional nylon/ nylon construction. Also, the drying time of the rope is dramatically reduced due to the polyester being non hydroscopic. An additional benefit is that there is no discernible strength reduction to the rope when wet. With full nylon/ nylon ropes up to 20% strength reduction can be expected when the rope is wet.
5. Longevity- The outer polyester cover providing a good characteristic for U.V. resistance. Due to its unique construction the rope will not work harden during standard use and will retain a consistent diameter throughout its life ensuring longer service than others.



Figure Eight Knot (Flemish Knot) is a quick and convenient stopper knot which can be undone fairly easily, and does not harm your rope as much as the overhand knot does.
How to make the Figure Eight Knot?

1. Make a bight in a rope.
2. Loop the other side through the bight.
3. Loop the loop x 2.
4. Pull.

RR-11B Double Braided Rope

Dia. 7/16" (11mm), 200M Per roll



Polyester cover Nylon core



200m Per Roll



Manufacturing



Testing

NORE: The ropes have no energy absorption and must never be used to hold a falling person or load.

PL-200 is a single phase wire winch, rated for load capacity 200kgs. Compact and lightweight design turns it perfect mobility on the move. Single-phased motor makes the operation quick, simple and easy as it can plug up in anywhere the AC power is on hand. It is fabricated with dia.5mm stainless steel wire rope in 30M lengths with lifting speed 23M/min (60Hz) or 19M/min (50Hz), rather ideal for those small-to-medium scales of venues or time-consuming rigging application with less heavy load. With its light-duty and portability, PL-200 can be the great rigging solution to the need.

Supplied with two handcuff couplers for ready to rig on 2" tube.

Heavy duty chassis for maximum durability.

Finished in matt black powder coating for less visibility.

Upper limit switch will be triggered when hook disc touches it; the motor will automatically stop for safety.



Dual braking system combines dynamic and mechanical braking, provides instant and safe braking.

Precision machined gears heat treated for strength and durability, the ball or needle bearings at all rotating points run in oil bath lubrication for a quieter, smoother and cooler operation.

Built up with insulation class F motor for 300 starts per hour; ED 30%.

The lower limit switch is designed in order to prevent wire rope under-wound.

360°swivel hook for freely movement; wire terminated with double aluminum sleeves for further security; thimble provides greatest protection to the wire from the wear of contacting latch.

PL-200 Wire winch

Dimension: 240 (L) x 180 (W) x 660 (H) mm, 15 kgs (N.W), 23 kgs (G.W)

Specification

Capacity (kg)	Power (Voltage)	Phase	Wire Rope (mm)	Wire Rope Lift (Meter)	Speed (M / min) 50Hz / 60Hz	Motor (KW)
200	100-120 / 200-240	1	5	30	19 / 23	1.2



CHC-11-1P

Single Phase One Channel Wire Winch Controller (1-CH Wire Winch Controller)

Built-up with impact-resistance compound plastic, this hand held direct controller provides handy operation for wire winch. Lockable E-stop button for immediately killing power. Up and down push button controls the travelling direction. 1.7M cables for both input and output, with CEE 2P+E connector (input) and 5 Pin connector (output).



www.fortlamps.ru +7495 749 66 09 info@fortlamps.ru

KUPO CO., LTD (Headquarters)
Tel : +886-2-2999-1906
Fax: +886-2-2999-1955
E-mail: stage@kupo.com.tw

**6F, No 4, Lane 609, Sec.5, Chung Shin Rd., San Chung District,
New Taipei City 24159, Taiwan**

Kupo Shanghai (Branch office)
Tel : +86-21-5677-9636

www.stage.com.tw

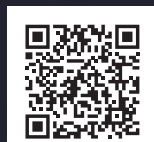

Product catalog download

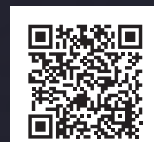

Product video channel

[NOTE] Whilst every effort has been made to ensure the accuracy of the information / material contained within this catalogue, Kupo does not accept any liability for errors or omissions. Specifications and technical data are provided for guidance purposes only. To improve products, we reserve the right to make any variation in design or construction to the equipment description without prior notice.

www.fortlamps.ru